



# CHEFTOP MIND.Maps™ ONE



ENGLISH

To respect the environment, we have decided to digitalize our catalogues and substitute them with this leaflet. With this decision, we have **reduced** our paper consumption by **up to 95%**. You can download the complete catalogue by scanning the QR code displayed here. Do you need more information? Visit our website and chat with us!

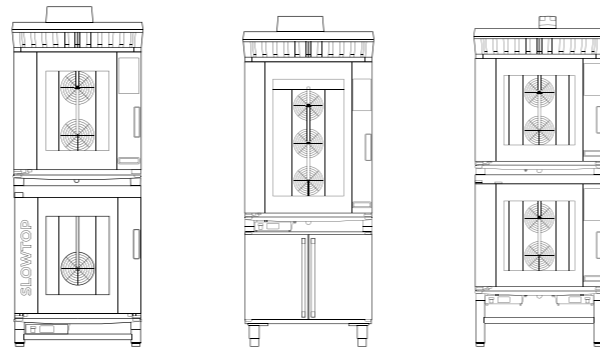

Configure your CHEFTOP MIND.Maps™ at [unox.com](http://unox.com)

LIT779A2



## Try the oven for free



Book

Set up an appointment, call us or book it online



Cook with us

Try the oven in your kitchen with one of our Chefs



Choose

Make a choice based on solid certainties

## The essence of a combi oven



CHEFTOP MIND.Maps™ ONE is the professional combi oven that allows you to obtain concrete cooking performances in a simple and intuitive way.

MIND.Maps™ ONE combi oven is available in four versions, to meet the specific needs of each kitchen:



CHEFTOP MIND.Maps™ PLUS COMPACT

Kitchens with small spaces and small shops



CHEFTOP MIND.Maps™ PLUS COUNTERTOP

Restaurants and deli shops



CHEFTOP MIND.Maps™ PLUS BIG COMPACT

Contract feeders and banqueting facilities



CHEFTOP MIND.Maps™ PLUS BIG

Contract feeders and banqueting facilities

## Cooking versatility

Unox Intelligent Technologies maximize your output and guarantee perfect cooking with any foodload.

**7 minutes**  
full load  
of crunchy bacon

**10 minutes**  
full load  
of grilled pork chops

**26 minutes**  
full load  
of steamed rice

**28 minutes**  
full load  
of steamed potatoes

**41 minutes**  
full load of roasted chickens (1,3kg)

**12 minutes**  
full load  
of sea bass fillet (0,3kg)

**22 minutes**  
full load  
of puff pastry

**14 minutes**  
full load  
of frozen demi-baguettes



Looking for more performance? Discover CHEFTOP MIND.Maps™ PLUS at [unox.com](http://unox.com)

## 4 years / 10.000 h Warranty

The LONG.Life4 extended warranty is the concrete proof of Unox reliability and the security of an investment that lasts over time.



1.

Connect the oven to the internet



2.

Register your oven at [ddc.unox.com](http://ddc.unox.com)



3.

Activate the LONG.Life4 warranty at [unox.com](http://unox.com)



4.

4 years / 10,000 hours worry-free

\* Check the Guarantee Conditions for your country at [unox.com](http://unox.com)





## Countertop combi ovens

CHEFTOP MIND.Maps™ ONE COUNTERTOP is the point of reference for each kitchen that needs solid performances, intuitive technologies and ease of use.



## Compact combi ovens

CHEFTOP MIND.Maps™ ONE COMPACT and CHEFTOP MIND.Maps™ ONE BIG COMPACT are the ideal solutions for professional kitchens that require maximum simplicity in the smallest footprint.



## Trolley combi ovens

CHEFTOP MIND.Maps™ ONE BIG is the ideal tool for large kitchens, that need simple technology, cooking quality and high productivity.

Discover all the oven features at unox.com



Electric

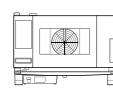

3 GN 1/1

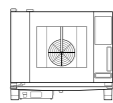

5 GN 1/1

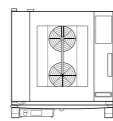

7 GN 1/1

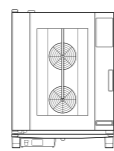

10 GN 1/1

### Give shape to your cooking skills

CHEFTOP MIND.Maps™ ONE COUNTERTOP is the professional combi oven that stands out for its simplicity. Nothing superfluous, nothing left to chance. Cook every dish being confident that you will always obtain the desired result.

up to **40%**

Less energy compared to a traditional grill

### Cooking Quality

Get the result you are looking for

up to **80%**

Less water compared to cooking in boiling water

### Savings

Energy, time and ingredients

up to **90%**

Less oil compared to a fryer

### Reliability

Effective technology, solid performances

Discover all the oven features at unox.com



Electric

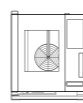

5 GN 2/3

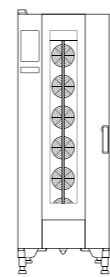

20 GN 1/1

### Concentrated power

CHEFTOP MIND.Maps™ ONE COMPACT is the ideal solution for professional kitchens requiring the least footprint and maximum performance.

**40 kg**

Maximum capacity 2 x 2 combination\*

\*Data refers to a 4 XECC-0523-EIRM ovens combination

**530 mm**

One of the narrowest ovens in its category

### Flexibility

Stack 2 units to enable different cookings at the same time

### Compact outside, big inside

CHEFTOP MIND.Maps™ PLUS BIG COMPACT professional trolley oven is the ideal tool for large kitchens, that need simple technology, to maximise productivity and space.

**90 kg**

Full load maximum capacity

**650 mm**

One of the narrowest ovens in its category

### Reduced footprint

Maximum productivity in just 0,65 square metres

Discover all the oven features at unox.com



Electric

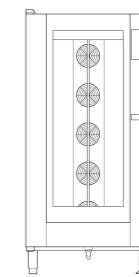

20 GN 1/1

### The essence of food production

CHEFTOP MIND.Maps™ ONE BIG is the professional trolley oven which allows you to make large quantities of cookings in a simple and intuitive way.

**90 kg**

Full load maximum capacity

**260 °C**

Maximum cooking temperature

**6.5 min**

Preheating time from 30 °C to 260 °C

Data refers to XEVL-2011-EIRS model

### Productivity

High volumes, zero stops

### Cooking Quality

Get the results you are looking for

### Reliability

Effective technology, solid performances