

FEATURES

- 1.2mm thick stainless steel
- Perfect stands for ATHP/ATMG/ATCB /ATRC Series
- Full stainless steel stand



ATSE-2824



ATSE-2836



ATSE-2848

INFORMATION	ATSE-2824	ATSE-2836	ATSE-2848
Dimensions(mm)	W615 x D711 x H610,18kg	W915 x D711 x H610,24kg	W1225 x D711 x H610,29kg
Packaging Dimensions(mm)	W640 x D740 x H180,20kg	W940 x D740 x H180,26kg	W1250 x D740 x H180,32.5kg

ATSE-2824

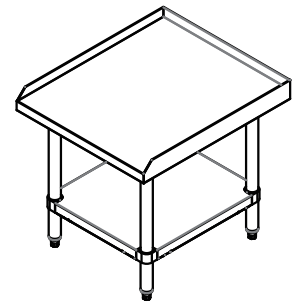
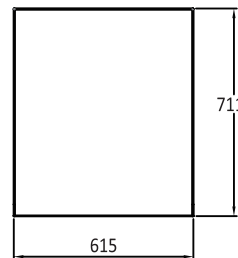
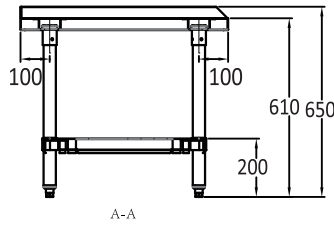
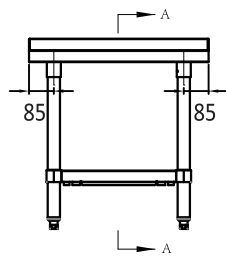

ATSE-2836

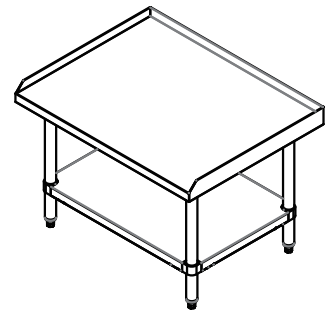
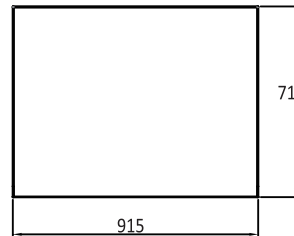
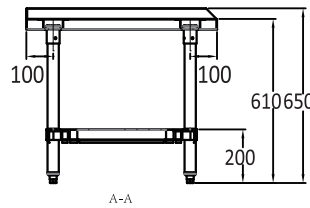
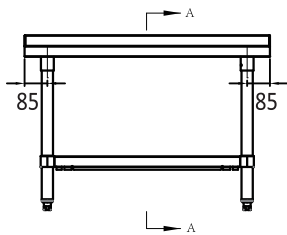

ATSE-2848

