

Instruction Manual

SYCLOID™ TOASTERS



ST350A	Version 3
ST500A	Version 3
Alternative Colours	...B, ...R
International Models	...-Bxx, ...-Fxx, ...-Gxx, ...-Mxx

CONTENTS

Product Features	2
Specifications	2
Parts Included	2
Safety Instructions	2
Cleaning & Maintenance	3
Installation	4
Operation	5
Troubleshooting	8
Spare Parts	10
Warranty	11

PRODUCT FEATURES

- Cool to Touch for User Safety
- Hinged Lid For Easy Cleaning
- Advanced Automatic Electronic Controls
- Automatic Bread Sensing
- Energy Saving Mode
- Ultra-Durable Stainless Steel Elements
- LED Lights Illuminating Toast Chute
- Easy Clean Crumb Tray

PERFORMANCE

Model	Toast Output
ST350A	Up to 350 slices per hour
ST500A	Up to 500 slices per hour

SPECIFICATIONS

Model	Power (230V)	Current (A)	Size (mm)			Kg
			W	D	H	
ST350A	2300W	10A	410	600	420	25
ST500A	2990W	13A	410	600	420	25

*Specifications subject to change

PARTS INCLUDED

- One Sycloid™ Conveyor Toaster (appropriate model)
- One Crumb Tray
- Instruction Manual

Any damage to the machine as a result of freight must be reported to the Freight Company and to the agent responsible for the despatch of machine within 24 hours of receipt. No claims will be accepted after this period.

SAFETY INSTRUCTIONS

Read all Instructions and safety warnings prior to use. Keep user manual for future reference.

Service and repair should only be performed by qualified technicians who have read and understand this manual.

Personnel must be trained prior to operating this appliance.

This product is suitable for commercial use only.

This machine should not be operated by persons (including children) with reduced physical, sensory or mental capabilities, or lack of experience or knowledge, unless they have been given supervision or instruction concerning the safe use of the appliance by a person responsible for their safety.

Keep out of reach from children.

Avoid contact with the exterior of this machine as surfaces can get hot.

Do not position appliances where hot surfaces may be accidentally touched.

The machine should be disconnected from all power and allowed to cool before cleaning or servicing.

Regularly inspect the supply cord/plug and discontinue use immediately if damage is found.

Return to manufacturer or authorised repairer for repair prior to use.

This machine contains no user-serviceable parts. Roband Australia, one of our agents, or a similarly qualified person(s) should carry out repairs.

Keep cord away from hot surfaces.

Do not remove any cover panels from the machine.

Do not open the top cover, remove crumb tray or touch parts near the cooking cavity until machine has cooled to room temperature.

NOTE: Machine is heavy. Always lift using 2 people and ensure top cover and crumb tray are securely in place.

These Toasters are intended for use with bread products without spreads or fillings.

Not suitable for pizza, buns or for unusually thick bread products.

Roband will accept no liability if:

- Non-authorised personnel have tampered with the machine
- The instructions in this manual have not been followed
- Non-original spare parts are used
- There is any damage to the unit

CLEANING & MAINTENANCE

CAUTION: Disconnect from power and allow to cool before cleaning.

CAUTION: Steel cutting processes used in the construction of this machine can result in sharp edges. Avoid contact with sharp edges during cleaning and maintenance.

Do not clean with the use of a water jet, immerse in water or allow the ingress of water into the ventilation holes or controls.

Do not use caustic or abrasive cleaning products as they will damage the machine.

Wipe outside surfaces of the machine with warm soapy water using a damp non-abrasive cloth.

Empty crumb tray on a daily basis and wipe with a damp cloth with warm soapy water.

Open the top cover and brush any excess dried crumbs from the inside of the toast cavity, lower elements and lower reflector. Brush the dried crumbs out of off the toast chute.

Regular cleaning will prevent a build-up of oils and keep the machine looking new.

Opening the Cover

Pull the cover release lever on the left hand side of the machine. Using your other hand, open the top cover. Do not move or bump the machine whilst the cover is open.

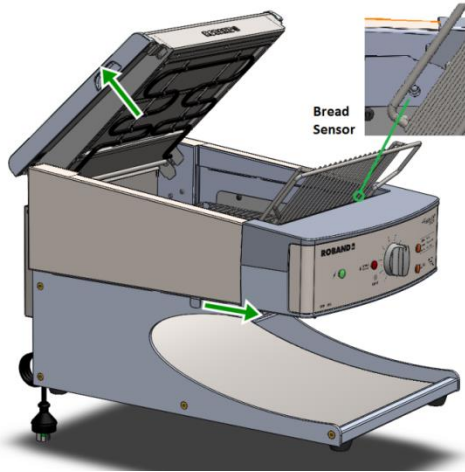

Remove Crumb Tray

To clean the crumb tray, slide forward as shown in the image below:

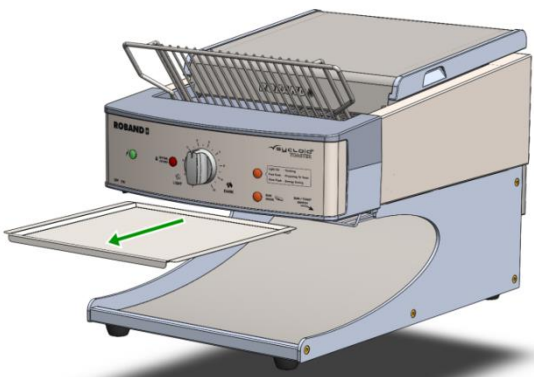

NOTE: Ensure that the crumb tray is replaced prior to use.

INSTALLATION

Remove all packaging materials, tape, and any protective plastic from the machine. Remove any glue residue from the protective plastic or tape using citrus cleaner.

Place the product on a firm, level surface in the desired position. Install at least 100mm from combustible materials and a least 50mm from any other appliance.

Minimum Installation Clearances

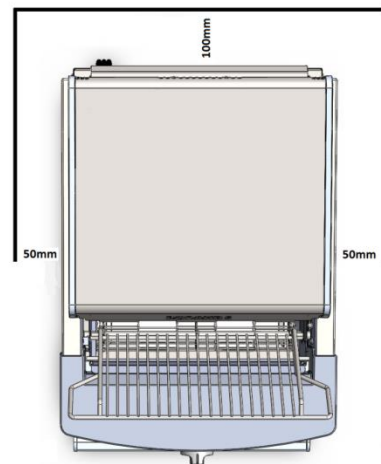

Do not connect to power using an extension cord.

Before connecting the machine to the power supply, ensure that all switches are in the OFF position. Connect only to a RCD protected, grounded 3-pin outlet.

The toaster is insulated and contains an internal cooling fan so that it remains safe to touch externally while operating. Good ventilation is required for this to function correctly.

NOTE: The toaster is not designed to be installed on top of other cooking equipment.

Remove the crumb tray packaging and insert the crumb tray into the toaster. If it has been removed for cleaning, please ensure that it has been replaced prior to use.

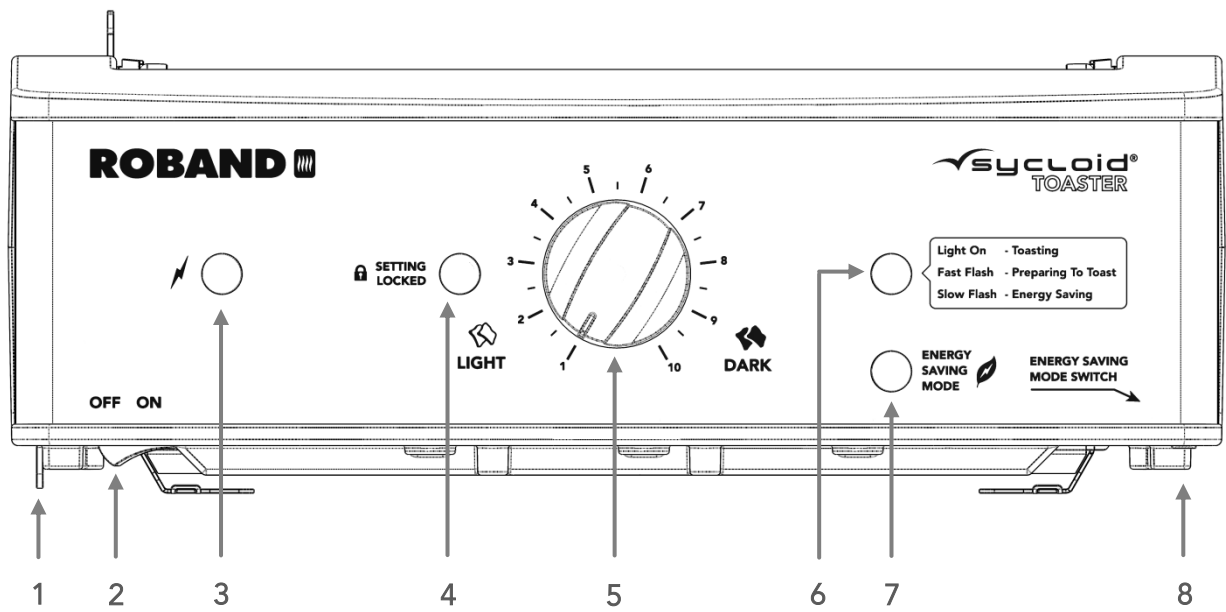

OPERATION

Description	Function
1 Top Cover Latch	Pull to release and open top cover
2 Power Switch	Turns toaster on/off
3 Green Pilot Light	Indicates power on
4 Red Pilot Light	Indicates conveyor speed is locked
5 Speed Control Knob	Changes conveyor speed
6 Amber Status Light	Indicates machine status
7 Energy Save Mode Amber Light	Indicates energy save mode is active
8 Energy Save Mode Switch	Switches energy save mode on/off

Switching your Toaster On

Turn power switch (#2) to on position, the green pilot light will indicate the machine is on.

Select Energy Save Mode, if desired, by setting energy save switch (#8) to ON position. Energy save light (#7) will be illuminated.

Energy Saving Mode Disabled

The elements are powered at 100% and the conveyor switches on immediately. The toaster

takes about 10 minutes to reach a constant cooking temperature.

Energy Saving Mode Enabled

Warm Up Cycle

When switched on, the toaster will begin its Warm-Up Cycle. During warm up, the elements will be powered at 100% and the amber status light will flash quickly.

The conveyor will switch on after 3 minutes of warm up.

Note: As a safety precaution the toaster will not perform a warm up cycle if the main switch is on when the mains power is supplied.

Toasting

After the warm-up cycle, the toaster is ready to use. The amber status light and the conveyor will remain on.

The toaster will remain in normal operation mode as long as it is being used.

During Energy Save Mode the toaster monitors toasting activity. If the toaster detects that activity has stopped, it will gradually shut down in three stages as follows:

1. Motor Saving Mode

After the toaster has been idle for a period of 5 minutes the conveyor motor turns off to save energy. The elements will remain on.

The conveyor automatically restarts when bread is placed on the chute.

2. Power Save Mode

After the toaster has been idle for a period of 30 minutes, it will enter Power Save Mode.

During this mode the element output is reduced and the conveyor remains off to save power.

This will be indicated by the slowly pulsing status light (#6). The toaster automatically wakes up from Power Save Mode when bread is placed on the chute.

When waking up from Power Save Mode the elements will be switched back to 100%. The status light will flash quickly the same way it does when the toaster warms up. The conveyor will move the bread into the cooking cavity, and will index on and off until full operating temperature has been reached. When at full temperature the conveyor will move continuously.

3. Sleep Mode

After the toaster has been idle for a period of 70 minutes it will enter Sleep Mode.

During this mode the elements are shut down completely and the conveyor will remain off. This will be indicated by a slow pulse on the status light (#6). The toaster automatically wakes up from sleep mode when bread is placed on the chute.

When waking up from sleep mode the toaster enters into a warm up cycle in the same way it does when the toaster is turned on for the first time at the start of operation.

Setting the Speed

Set the speed control knob to about 5 as an initial speed setting. Place 1 or 2 slices of bread on the bread chute and check the results when finished.

Adjust the speed control if required. This can be adjusted faster or slower to achieve lighter or darker cooking as required.

Speed Locking

If desired, the toaster can be locked at any conveyor speed.

To lock a conveyor speed, perform the following steps:

1. Rotate the speed control knob fully to the left, then fully to the right, rapidly, and keep repeating until the red light flashes quickly.
2. While the red light is flashing set the conveyor speed to the desired position and release the knob.
3. After 10 seconds of no rotation the speed will be locked to the set position and the red light will remain on indicating that the speed is locked.

To unlock a locked conveyor speed, perform the following steps:

1. Rotate the speed control knob fully to the left, then fully to the right, rapidly, and keep repeating until the red light is switched off.
2. The conveyor will be unlocked and the red light will switch off.

Fault Modes

In the event of a fault, the machine will enter Fault Mode.

During Fault Mode, power to the elements and the conveyor will be shut down until the fault is rectified.

Some lights will flash depending on the fault. Please check the Troubleshooting section for help on identifying a fault.

1. *Cover Open*

If the cover is opened during operation, power to the elements and the conveyor will be turned off immediately. The amber status and red pilot light will flash alternately.

When the cover is closed the machine will resume normal operation.

The cover should not be opened during normal operation, only when cool.

2. *Motor Failure*

If the motor fails, power to the elements will be turned off immediately. The status and speed lock lights will flash together.

Call for assistance from a licensed service agent.

3. *Over Temperature*

If the toaster cooling system is compromised and the internal temperature reaches 80°C, power to the elements will be turned off immediately and the conveyor will continue to run so that nothing is left inside the cooking cavity.

The status and speed lock light, as well as the LED light strip will flash together.

Allow the machine to cool down before trying to cook again. If the problem persists, call for assistance from a licensed service agent.

Switching Off the Machine

When switched off, the cooling fan will continue to run on for period of 10 minutes to cool the toaster down.

It is recommended that the machine be disconnected from mains power after the completion of cool down and when not in use.

Operating Tips

- Best results are obtained by using day old bread, which has lost some of the moisture inherent with fresh bread.
- Different breads will have different toasting properties. Using the same brand of bread will result in more consistent toasting through user familiarisation.
- When you establish your desired cooking level consider locking the speed to ensure consistent results.
- Regular cleaning of the crumb tray is essential.

TROUBLESHOOTING

If the Toaster does not function check the following points before calling for service.

- ✓ The machine is plugged in correctly and the power switched on.
- ✓ The power point is not faulty.
- ✓ The on/off switch is not in the OFF position.
- ✓ The Lid is in the closed position. The amber and red pilots will flash alternatively if the lid is opened.

If the conveyor stops during operation:

- ✓ The machine may be in Power Save Mode. Check the flash condition of the amber pilot. Put bread in and see if it will start automatically.
- ✓ If smoke is coming from the cooking cavity, turn off the machine and allow it to cool. Open the top cover and check for anything stuck in the conveyor.

If the machine does not enter Power Save Mode:

- ✓ Check the bread sensor works (see Sensor Test Mode). Note that if the bread sensor does not work the machine will never go into Power Save Mode.

If appliance is tripping RCD, this may be caused by:

1. Too many machines on the same circuit (relocate appliance to another circuit and try again);
2. Faulty appliance; or
3. Moisture absorption into heating element.

Tubular heating elements are subject to moisture absorption which can result in RCDs (residual current devices) tripping, particularly when the appliance is not used for an extended period, or stored in humid conditions.

Regular use can avoid moisture absorption.

SENSOR TEST MODE

Step 1: Place the machine in Sensor Test Mode

This test can be used to test the operation of the bread sensor and conveyor motor.

CAUTION: Ensure the toaster is cold.

Do not use this procedure if the toaster is hot.

- Turn the machine ON and set the Energy Save Mode switch to ON.
- Switch the machine OFF.
- Open the top cover using the release lever located on the left hand side. The elements will not activate while the cover is opened.
- Switch the main on/off switch 5-times rapidly **ON-OFF-ON-OFF-ON-OFF-ON-OFF-ON** This needs to be done in about 5 seconds to complete the action successfully.
- Upon entering the Sensor Test Mode the red pilot light will double flash.
- Block the bread sensor beam by pushing the bread chute away from you so that it is in front of the hole near the bottom right hand side of the bread chute.
While the bread sensor beam is **blocked**, the conveyor motor will start moving and the amber status light will turn on.
While the bread sensor beam is **unblocked**, the conveyor motor will stop moving and the amber status light will turn off.

Step 2: Place the machine back in Normal Mode

- Close the cover
- Turn the machine OFF. Wait for a minimum of 1 second.
- Turn the machine ON. The toaster will start in warm up mode as usual.

Indicating Lights

Use this table to help diagnose the machine status.

Status	Amber Status Light	Red Light	Chute Lights
Warm Up	Quick flash	Off	On
Normal	On	Off	On
Speed Locking	On	Quick flash	On
Speed Locked	On	On	On
Speed Unlocked	On	Off	On
Motor Save	On	Off	On
Energy Save	1 second flash	Off	On
Sleep	2 second flash	Off	On
Cover Open	1 second flash alternately		On
Motor Failure	2 second flash together		On
Over Temp.	4 second flash together		
Sensor Test: Beam blocked	On	Double flash	Off
Sensor Test: Beam unblocked	Off	Double flash	Off

SPARE PARTS

Common

EC0031	Terminal Block
EC0158	Switch - Rocker
EC0439	Ø60 x 180 Tangential Fan
EC0440	Speed Control Pot Assembly
EC0447	6 x LED Lighting Strip
EC0461	Toast Sensor w/ Bezel - IR
EC0737	Control Board
ES0264	Pilot Light and O-ring, Amber
ES0265	Pilot Light and O-ring, Green
ES0321	Pilot Light and O-ring, Red
ES0406	Motor & Gearbox Spares Kit
MC1026	Latch Spring
MC1034	Drive Chain
MC1037	Tension Spring
MC1038	Machined Bush
MC1039	Wire Belt
MC1048	R Clip
MS0565	Knob with 300° Rotation Insert
PC0482	90° Cord Grip
SS2732	LH Outer Side
SS2733	RH Outer Side
SS2738	Crumb Tray
SS2998	Bread Stopper
VS0265	Microswitch & Bracket Assembly
VS0289	Conveyor Idle Shaft Assembly
VS0290	Conveyor Drive Shaft Assembly

ST350A

EC0239	Plug & Cord - 10A
HC0221	1030W 230V - Top Element
HS0026	1180W 230V - Bottom Element & Reflector Assembly

ST500A

EC0306	Plug & Cord - 15A
HC0220	1350W 230V - Top Element
HS0025	1550W 230V - Bottom Element & Reflector Assembly

ST350A - International Models

-Bxx	EC0433	Plug & Cord - 15A - Type B
-Gxx	EC0281	Plug & Cord - 13A - Type G

ST500A - International Models

-Bxx	EC0433	Plug & Cord - 15A - Type B
-Fxx	EC0137	Plug & Cord - 15A - Type F
-Gxx	EC0558	Plug & Cord - 13A - Type G
-Mxx	EC0384	Plug & Cord - 15A - Type M

WARRANTY

The warranty conditions set out below are in addition to any warranties implied or governed by law.

Roband Australia warrants that this appliance shall be delivered free from defects in material and workmanship. The warranty for this product is offered to the original purchaser, to be free of fault in both workmanship and materials for a period of 12 months from date of purchase. Roband's obligations pursuant to this warranty are limited to the repair or replacement of the defective goods or materials, at its discretion and subject to the terms contained within this Warranty statement.

The following conditions apply:

The product must be installed, maintained and used under normal operating conditions within the scope of the operating instructions.

All warranty claims must be submitted to Roband or an authorised Roband dealer, and Roband authorisation must be granted prior to repairs being carried out. Proof of purchase is required for any repair authorisation.

Warranty is back to base, meaning delivery to and collection of your product to Roband or an authorized service agent is the responsibility of the purchaser.

Where a product cannot be returned back to base, on-site warranty can be arranged by prior agreement.

The following exclusions apply:

Claims or faults arising from misuse, neglect, transport damage or other mechanical damage, including but not limited to; door's, hinges & interlock switches etc., other than those arising from manufacture or material defects. Where relevant, glass, Teflon® and lamps are not included in this warranty and RCD tripping due to moisture absorption by Tubular Heating Elements is not a warranty fault.

Roband or any subsidiary company or Agent shall not be liable for loss of profit or damage to other equipment and property except where it is in breach of the guarantees provided in accordance with applicable legislation.

Roband reserves the right to reject a warranty claim if it is not satisfied with the circumstances under which the fault occurred or where a product has been altered from its original specification.

For on-site repairs outside of capital city metropolitan areas, travel costs, service callout fee and related labour costs etc. are the responsibility of the claimant.

Any costs incurred for false claims or faults due to incorrect usage etc. are the responsibility of the claimant.

Any attempt to repair the product by non-Roband approved service personnel or the use of non-genuine parts will void the warranty agreement

Our goods come with guarantees that cannot be excluded under the Australian Consumer Law. You are entitled to a replacement or refund for a major failure and compensation for any other reasonably foreseeable loss or damage. You are also entitled to have the goods repaired or replaced if the goods fail to be of acceptable quality and the failure does not amount to a major failure.

For the name of your nearest Australian authorised service agent, please contact:

Roband Australia Pty Ltd
1 Inman Road,
Cromer, NSW, 2099, Australia
Warranty: 1800 268 848
Tel: +61 2 9971 1788
Fax: +61 2 9971 1336
Email: sales@roband.com.au
Web: www.roband.com.au

For your nearest International distributor,
please visit:
<https://www.roband.com.au/worldwide/>



© Copyright 2019 – Roband® Australia Pty Ltd

All rights reserved. No part of this work may be reproduced or copied in any form or by any means, electronic or mechanical, including photocopying or posting to a website, without the written permission of the publisher. The material contained within this document is intended entirely for instructional Purposes. Roband® Australia is a wholly Australian owned company and has been manufacturing quality commercial catering equipment for the food service industry for more than 50 years.

11/06/2020