

**Model**

EC20

**Product Description**

EC20 – High Volume Electric Chipper

**Product Code**

5EC22

**Standard Features**

- Production capacity of over 25kgs of chips per minute, 192 rpm
- Total capacity of 20kgs, including hopper
- Interchangeable knife assembly offers a choice of four chip sizes: 10mm, 12mm, 14mm & 16mm
- The unit is not supplied with a knife assembly, please specify your preferred chip size(s) when ordering
- For use with peeled potatoes
- Vee belt drive pulley for reliability and strength
- Manufactured from high grade 304 food safe stainless steel extending product life
- Heavy duty machined components for longer product life
- Thicker gauge material for a solid, more robust product
- Hopper, knife assembly and rotary feed are all removable for easy cleaning without the need for complicated removal tools
- All removable parts are dishwasher safe
- Stainless steel hopper with built-in ingredient baffles allows free movement of potatoes
- Zero volt reset preventing unplanned start-ups
- Safety interlocked hopper and knife block preventing unsafe use
- Emergency stop button, IP65 rated, preventing ingress of water
- Hand screw locking mechanism ensuring a full stop occurs before access to rotating parts
- Motor thermal protection preventing overheating and damage
- Counter-top mounting or optional floor stand available
- Non-slip feet preventing unwanted chipper movement
- CE & UKCA approved

**Included as Standard**

1 x EC20 – High Volume Electric Chipper

**Warranty**

Covered by Metcalfe 2-year warranty and full after sales service

## Optional Accessories

Part No	Item	Part No	Item
9ECM01	10mm Knife Assembly	9ECM03	14mm Knife Assembly
9ECM02	12mm Knife Assembly	9ECM04	16mm Knife Assembly
5EC24	Floor Stand	5EC25	Floor Trolley

## Dimensions

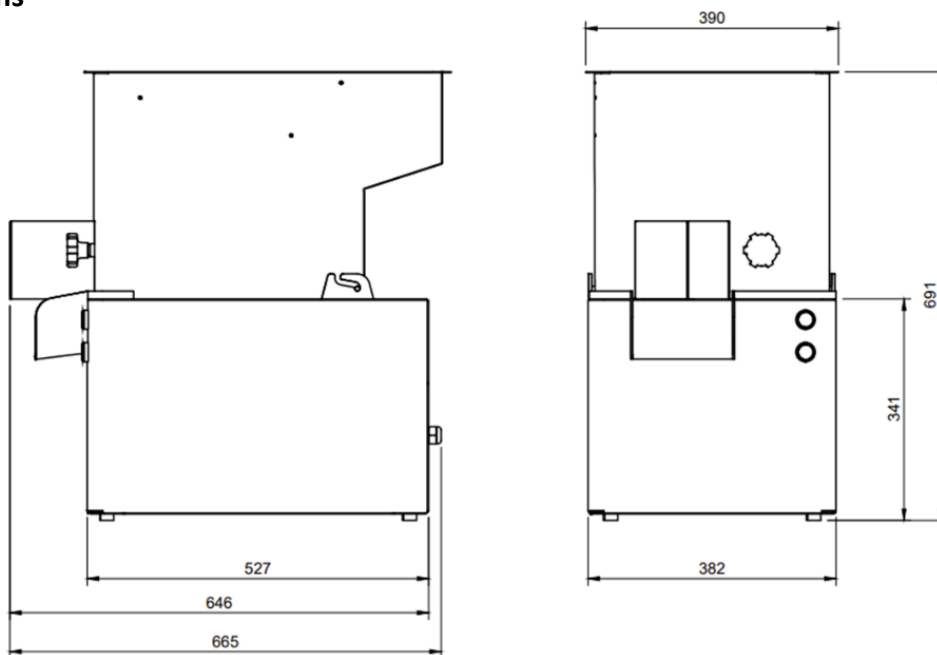

## Specifications

Model	Product Code	Capacity (kgs)	Output (kgs per min)	Phase (Ø)	Motor (V/Hz)	Power (kW/hp)
EC20	5EC22	20	25	1	230 / 50	0.18 / 0.25

## Dimensions | Shipping Information

Model	Overall Dimensions D x W x H (mm)	Net Weight (kg)	Packed Dimensions D x W x H (mm)	Packed Weight (kg)	Volume (m3)
EC20	665 x 390 x 691	48	720 x 410 x 835	53	0.25

We reserve the right to alter the specification and technical details for this item at any time without prior notice. 04/2022

## Metcalfe Catering Equipment Ltd

Haygarth Park  
Blaenau Ffestiniog  
Gwynedd, LL41 3PF

